

Flat 3 418 Wilbraham Road, Chorlton, Manchester, M21 0SD



JP&Brimelow
ESTATE AGENTS

Offers In The Region Of £110,000

****VIDEO TOUR AVAILABLE**** A STUDIO apartment, situated on the top floor of this period end of terrace property positioned above the North Star Delicatessen here on Wilbraham Road. Situated in a central location in Chorlton on a highly popular road. Within strolling distance to the centre of Chorlton with all its independent shops, bars, restaurants, parks and the Metrolink on Wilbraham Road, giving direct access into the City Centre and Media City. The well-planned accommodation consists of; a private entrance hall, an open plan living/bedroom space to the front aspect, a fitted kitchen, and a white three-piece shower room. The property benefits from partial double glazing, warmed by gas fired central heating with a communal boiler. Would ideally suit a professional, a couple or an investor due to the location. OFFERED WITH NO VENDOR CHAIN. Early internal viewing is highly recommended.





EPC Chart

Energy Efficiency Rating		
	Current	Potential
Very energy efficient - lower running costs		
(92 plus) A		
(81-91) B		
(69-80) C		
(55-68) D		
(39-54) E		
(21-38) F		
(1-20) G		
Not energy efficient - higher running costs		
	62	75
England & Wales		EU Directive 2002/91/EC



Tenure: **Leasehold** Council Tax Band: **A**

Top Floor

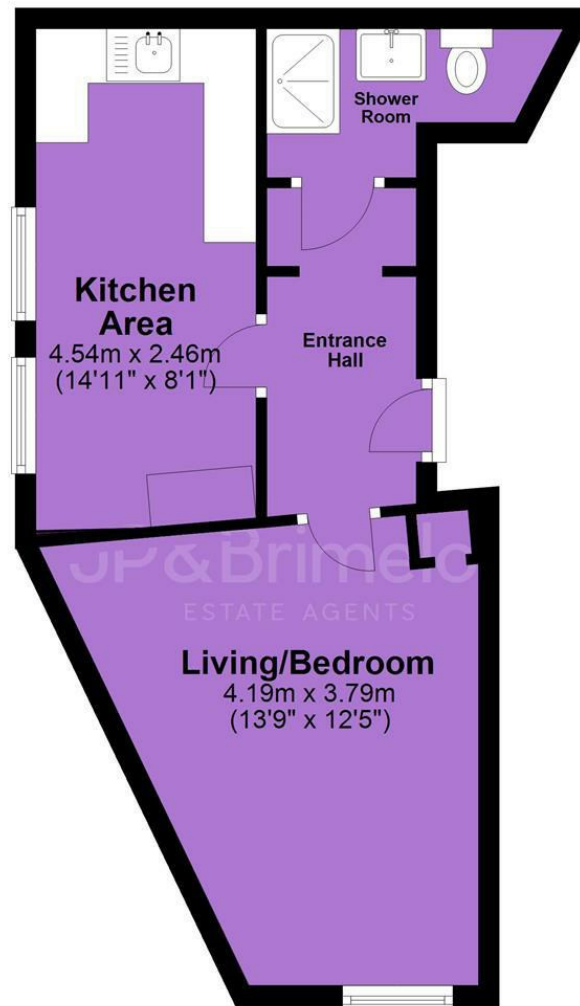

Chorlton & Didsbury Ltd
 430 Barlow Moor Road, Chorlton, Manchester, M21 8AD
 Chorlton: 0161 882 2233 Didsbury: 0161 448 0622
 E: chorlton@jpbrimelow.co.uk www.jpbrimelow.co.uk



JP & Brimelow
 ESTATE AGENTS

NOTICE: J P & Brimelow Chorlton & Didsbury Ltd for themselves and for the vendors or lessors of this property whose agents they are give notice that:

- (i) the particulars are set out as a general outline only for the guidance of intending purchasers or lessees, and do not constitute, nor constitute part of, an offer or contract;
- (ii) all descriptions, dimensions, references to the condition and necessary permissions for use and occupation, and other details are given in good faith and are believed to be correct but any intending purchasers or tenants should not rely on them as statements or representations of fact but must satisfy themselves by inspection or otherwise as to the correctness of each of them;
- (iii) no person in the employment of JP & Brimelow Ltd has any authority to make or give any representation or warranty whatever in relation to this property.



Follow us on Twitter @jpandbrimelows